

Алматы (7273)495-231
Ангарск (3955)60-70-56
Архангельск (8182)63-90-72
Астрахань (8512)99-46-04
Барнаул (3852)73-04-60
Белгород (4722)40-23-64
Благовещенск (4162)22-76-07
Брянск (4832)59-03-52
Владивосток (423)249-28-31
Владикавказ (8672)28-90-48
Владимир (4922)49-43-18
Волгоград (844)278-03-48
Вологда (8172)26-41-59
Воронеж (473)204-51-73
Екатеринбург (343)384-55-89

Иваново (4932)77-34-06
Ижевск (3412)26-03-58
Иркутск (395)279-98-46
Казань (843)206-01-48
Калининград (4012)72-03-81
Калуга (4842)92-23-67
Кемерово (3842)65-04-62
Киров (8332)68-02-04
Коломна (4966)23-41-49
Кострома (4942)77-07-48
Краснодар (861)203-40-90
Красноярск (391)204-63-61
Курск (4712)77-13-04
Курган (3522)50-90-47
Липецк (4742)52-20-81

Магнитогорск (3519)55-03-13
Москва (495)268-04-70
Мурманск (8152)59-64-93
Набережные Челны (8552)20-53-41
Нижний Новгород (831)429-08-12
Новокузнецк (3843)20-46-81
Ноябрьск (3496)41-32-12
Новосибирск (383)227-86-73
Омск (3812)21-46-40
Орел (4862)44-53-42
Оренбург (3532)37-68-04
Пенза (8412)22-31-16
Петрозаводск (8142)55-98-37
Псков (8112)59-10-37
Пермь (342)205-81-47

Ростов-на-Дону (863)308-18-15
Рязань (4912)46-61-64
Самара (846)206-03-16
Санкт-Петербург (812)309-46-40
Саратов (845)249-38-78
Севастополь (8692)22-31-93
Саранск (8342)22-96-24
Симферополь (3652)67-13-56
Смоленск (4812)29-41-54
Сочи (862)225-72-31
Ставрополь (8652)20-65-13
Сургут (3462)77-98-35
Сыктывкар (8212)25-95-17
Тамбов (4752)50-40-97
Тверь (4822)63-31-35

Тольятти (8482)63-91-07
Томск (3822)98-41-53
Тула (4872)33-79-87
Тюмень (3452)66-21-18
Ульяновск (8422)24-23-59
Улан-Удэ (3012)59-97-51
Уфа (347)229-48-12
Хабаровск (4212)92-98-04
Чебоксары (8352)28-53-07
Челябинск (351)202-03-61
Череповец (8202)49-02-64
Чита (3022)38-34-83
Якутск (4112)23-90-97
Ярославль (4852)69-52-93

Россия +7(495)268-04-70

Казахстан +7(7172)727-132

Киргизия +996(312)96-26-47

<https://amphenol.nt-rt.ru/> || aox@nt-rt.ru

Amphenol

Cable Assemblies

Amphenol’s cable assemblies include simple point-to-point cables, custom high-power and high-speed data cable assemblies and complex multi-branch harness assembly for large systems across a broad range of end markets. Our cable assemblies include the latest industry innovations in radio frequency (RF), fiber optics, high-power requirements and high-speed data transfer for the newest systems and applications. In addition, our broad portfolio of cable connectors and accessories can be used in our cable assemblies to provide a complete solution.



10G SFP+ Loopback Modules

10G PORT TESTING SOLUTION Amphenol's 10G SFP+ MSA compliant Loopback Modules are part of Amphenol's comprehensive copper cable and connector product family. Offered as passive electrical, our SFP+ Loopbacks come with and without EMI spring fingers. Loopbacks without EMI spring fingers reduce the insertion and extraction force.



180° Clocked RF Cable Assemblies

SV Microwave has just released a series of 180° clocked cable assemblies that feature right-angle connectors positioned in opposing directions. These high-performance assemblies have been configured to maximize space in applications with tight routing. These fixed-length 6" and 12" cable assemblies are available in SMP and SMA series in both Ø.047" and Ø.085" cable types.



5G Flex® 18 Assemblies

5G Flex Assemblies are dependable and flexible, outdoor rated, general-use coaxial cable assemblies fitting for many 5G applications. Utilizing Times Microwave's cable heritage, these assemblies will withstand the test of time while providing reliable electrical performance.



5G Flex® 28 Assemblies

5G Flex Assemblies are dependable and flexible, outdoor rated, general-use coaxial cable assemblies fitting for many 5G applications. Utilizing Times Microwave's cable heritage, these assemblies will withstand the test of time while providing reliable electrical performance.



75 OHM D38999 Circular RF Cable Assemblies

SV Microwave just released fixed-length 75 Ohm RF MCX Cable Assemblies for series SMPM, SMPS and BMZ. These cable assemblies have been designed to fit into any D38999 housing and have a true 75 Ohm impedance construction that assures a high fidelity signal in 3G SDI, 4K and 8K video feeds.



AARC

Widely used across the mobile networks industry. Amphenol's harsh environment AARC plug and receptacle assemblies are available in 2-fiber or 4-fiber configurations. Based on the N-Type RF threaded connector housing, this interconnect system provides superior optical performance in outdoor environments using LC-style 1.25mm ceramic ferrules.



Active Optical Cables

AOC series includes QSFP28 AOC, QSFP+ AOC, SFP28 AOC, SFP+ AOC, QSFP28 to SFP28 BO, and QSFP+ to SFP+ AOC BO, compliant with MSA and other standards. It is characterized by low power consumption, small size, and high reliability, which is beneficial to increase capacity of data centers, improve port density, and reduce power consumption.



Airbag Harness

Cable Assembly with high-quality manufacturing & control



Amphenol Custom Cable Configurator

Custom Cable helps its clients connect technology by providing high-quality products through a unique custom configurator. Create an account today to receive immediate and real-time quotes for standard and custom optical and copper assemblies, as well as many other misc. minor materials.



AN/PRC 117G & 152 Military Radio Data Cables and Connectors

Amphenol Tactical Communication (ATC) connectors and cable assemblies are designed to interface with the AN/PRC-117G and AN/PRC-152 military radio 32 pin data connector. The ATC connectors are designed to be used in harsh environment applications and feature a rugged, watertight two (2) piece metal shell design. Enhanced EMI-shielding capabilities ensure superior performance.



Automotive Cable Assemblies China / Asia

Customer and application-specific cable assemblies for all electric functions in a vehicle. Harness assemblies including standard connectors and customized interconnect solutions.



Automotive HF / Coaxial Harness Assemblies China / Asia

Automotive HF / RF components and harness assemblies to connect antennas, cameras, radio, infotainment, and connectivity modules. All commonly used standard interfaces like FAKRA GEN3 / GEN4 and MiniCoax / Mini FAKRA are available.



Bare Fiber Optic Cables

High-quality fiber end faces, without connectors, ferrule, and coating, are a prerequisite and challenge at the same time for some applications due to their fragility. With our possibilities and experience, your fiber ends get an optimal surface according to your requirements.



Battery and Miscellaneous Cables

Unlimited Services manufactures heavy-gauge battery and miscellaneous cables, often kitted with wire harnesses, for on-road and off-road specialty vehicles and military ground vehicles. Production volumes range from low to medium volume. Production resources are in the U.S. Our heavy cable processing capability and engineering design review delivers quality, with ITAR certification and DoD MLAs.



Build-to-Print Harness Assemblies

Various build-to-print cable assemblies including different processes such as potting, overmolding, and electrical welding



Cable and Wire Harnesses

Amphenol Borisch Technologies has a long history of manufacturing complex cable and wire harnesses for a broad range of harsh environment defense and aerospace applications. Our capabilities include over-molding, custom backshells, unique cable transitions, braiding for EMI/RFI and mechanical abrasion production, rapid prototyping, live-layup, test, X-ray, and custom fixtures.



Cable Assemblies

Amphenol's cable assemblies are widespread in the market for wearable products. These cable assemblies are used for data transfer and power charging. Amphenol's Charger Cable Solutions provide highly flexible customized connection solutions from standard USB 2.0/3.0 to the device side with Pogo pins or Spring. The connection mechanisms include magnetic, buckling, clamping, cradle, etc.



Cable Assemblies - Connectivity

Tecvox supplies a full range of high-speed data cable assemblies including USB, HSD, LVDS, HDMI, and emerging Type C interfaces. Tecvox data management cables complete connectivity networks, supplying fully validated systems to our customers.



Cable Bundles and Lead Assemblies

Amphenol-CTI manufactures cable bundles and lead assemblies for a wide range of industries and applications. We can execute on orders of low or high volume requiring high automation or detailed work. Certifications: UL, CSA, ISO9001, CE, IPC620, WHMA, C-PAP, IATF16949 (and others). Capabilities: Low & high volume / Small gauges (30+) / Seals, grommets / Tooled for multiple connectors suppliers

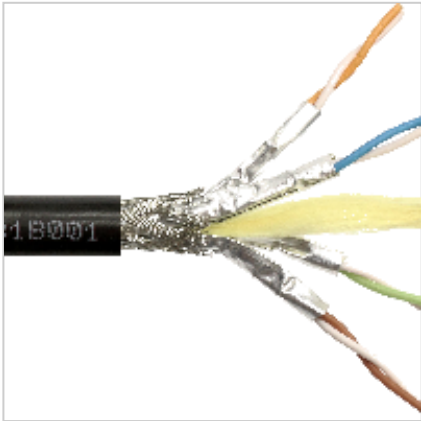

CAT7 Ethernet Cable

CAT7 Ethernet cable with VG95218T031 Type B001; Type C001 and Type C002 approval for secure data transmission in all defense, marine, aviation and industrial applications. Approved for data connectors up to CAT6A as per VG96912. Available by the meter, starting at 1 m.



CCS1 EVSE Cable Assy

CCS1 EVSE cable assembly for Charging Electrical Vehicles. MADE IN USA 200A, 125A, and 65A assemblies options UL2251 with UL62 cable rated with outstanding flexibility performance.



Chassis & Safety Harness

Electrical Liftgate System - contactless and quiet opening and closing of the boot is ensured by electric spindle drives. We manufacture these cable harnesses and the corresponding components on automatic production lines. Process steps such as overmolding inserts, automated clamp assembly, induction soldering, and casting are carried out according to customer specifications.



Cluster Jumper Cable

MQ8 PCB mount connector with 8 ports blind mate multi coaxial cable assembly.

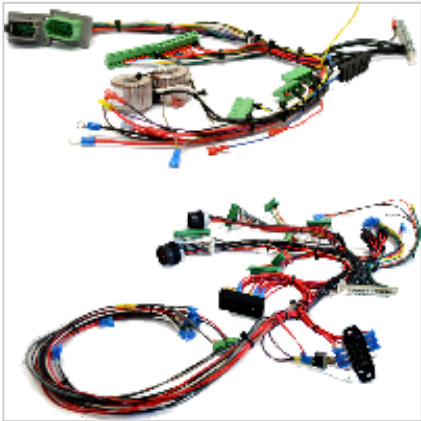

Complex Harnesses

Amphenol CTI manufactures wire harnesses and cable assembly solutions of any complexity for a broad range of industries and applications. Certifications: UL, CSA, ISO9001, CE, IPC620, WHMA, C-TPAT, IATF16949. Capabilities: Complex circuits counts / 70+ ft long / Harsh environment / Complex branching & bundling / Splices / Braiding. Tooled for many major interconnect suppliers



Conformable RF Cable Assemblies

SV Microwave's conformable RF cable assemblies can be easily formed by hand. The braided outer shield of the standard flexible cable is replaced with a tin-plated outer braid that is durable but flexible. Conformable or hand-formable cable assemblies are ideal when the cable bends must be determined during the installation of the assembly.

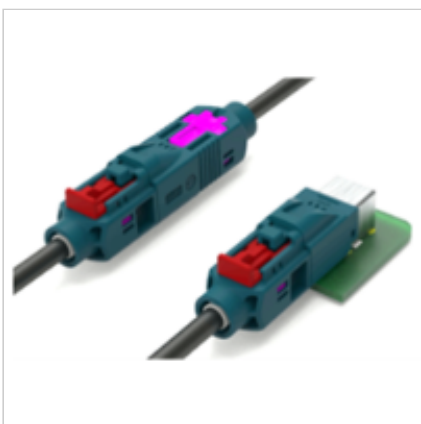

Connectivity Products - North America

We offer highly automated Cable Assemblies for Low & High Speed Automotive Ethernet. High reliable and tested Cable Assemblies for standard interfaces (acc. ISO 8092-6) supporting Low Speed Ethernet 100 Mbps and 1 Gbps UTP (IEEE 802.3bw), 1 Gbps STP (IEEE 802.3bp / Open Alliance TC9) and High Speed Ethernet - 10+Gbps STP / SPP (IEEE 802.3ch).



cStack™ Flex Cables

Amphenol's cStack™ flexible circuit assemblies are designed for applications where flexibility, space, weight, and performance are critical. They are available in standard and custom flex circuit and connector designs. cStack™ Flex is a compression-based interconnect utilizing Amphenol's cStack™ interposer terminated to a multi-layer impedance-controlled flexible circuit in a compact footprint.



Custom Cable Assemblies & Connectors

Creating value by integrating technologies is one of our core competencies. Leveraging the extraordinary breadth of technology found across the Amphenol portfolio, as well as our strategic sourcing partners, we have unfettered access to the latest developments in design, materials, and manufacturing methodologies of cable assemblies.



Custom Complex Cable & Harnesses

Amphenol DC Electronics is a custom cable assembly and wire harness manufacturing company. We specialized in the design, engineering, and manufacturing of complex cable harnesses. We are known for quick and comprehensive customer service as well as consistency in producing products that are manufactured to rigorous quality standards and demanding production schedules.



Custom Flex Cables

Amphenol's Flex Cable Assemblies provide value-added solutions to challenging interconnect problems where a flexible solution is desirable. Amphenol flex cables can be engineered to use any mezzanine connector in the Amphenol portfolio to meet unique signal integrity, mechanical, power, and environmental requirements.



Custom Molded Cables for Harsh Environments

Amphenol offers high-performance injection-molded cable assemblies (PVC, TPU, LSZH, and Polyurethane). Amphenol performs potting and encapsulation with MIL-M 24041 epoxies. Our mold library supports most Amphenol and Mil-Spec connectors. With vast adhesion studies made on new plating materials, superior over-molding is achieved.



CXP2 Active Optical Cable

HIGH DENSITY, EXCELLENT PERFORMANCE AND RELIABILITY Amphenol's 300G CXP2 to CXP2 Active Optical Cable is a natural choice for optical cabling in data center/high-performance computing hardware applications, providing a cost-effective plug-and-play cabling solution. The CXP2 form factor delivers the highest hardware faceplate port density among existing SFF industry standards.



CXP Passive Copper Cable Assemblies 120G/168G/300G

Amphenol's CXP passive copper cable assemblies are designed to meet the high bandwidth capacity demands being requested by data centers and high-performance computing applications. The CXP copper cables are a high-density cabling interconnect system capable of delivering aggregate data bandwidths of 120Gb/s and 168 Gb/s.



D38999 RF Contact Cable Assemblies

Amphenol SV Microwave offers high-frequency BMA and SMPM D38999 cabled RF contacts (size 8, 12 & 16) to SMA male connectors on Ø.085 and Ø.141 cable types that populate standard D38999 circular connectors. These fixed-length cable assemblies allow you to expand the use of the standard D38999 circular connector to incorporate microwave transmission lines.



Data Cable Assemblies China / Asia

Cable and Harness assemblies for vehicle data communication including HSD, Low, and High Speed Ethernet, FAKRA and MiniFAKRA



DIN IDC Cable Connectors and Cable Assemblies

FCI Basics DIN IDC cable connectors are available in 4 connector sizes as 96, 42, 21, and 9 positions. Available in wire sizes 30AWG to 24AWG, their unique insulation displacement design grants the lowest installed cost for users. Standard accessories are also offered to make up a fully modular system.



Direct Connect Trunks

Amphenol hybrid or discrete trunks offer power/fiber connectivity that is optimized for fast deployment and easy installation in FTTA. A single trunk enables connectivity to several RRHs without the need for a tower top distribution box. The metal canister breakout point provides a secure and reliable hoisting and grounding mechanism, while also delivering a fully sealed and robust transition.



Distributed Power & Control / Factory Automation Cables

Distributed power and control, factory automation cable assemblies, and connectors for use in most robotic and material handling systems, such as conveyors, sorting, automated storage and retrieval, packaging, overhead transport, palletizing, and any other options imaginable.

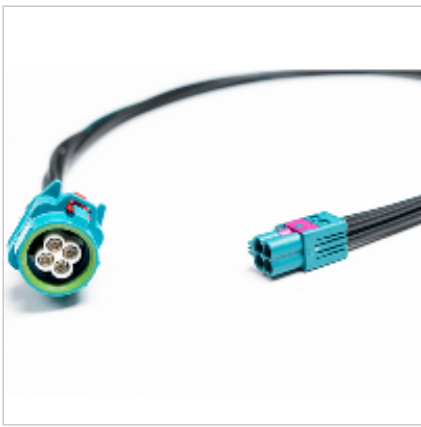

Driver Assistance Components

RF Connectors for transmitting LVDS and Multi-Gig-Ethernet. We offer cable assembly solutions needed to transfer data within a vehicle. These are used to connect cameras, antennas as well as Radar/Lidar systems and enable scanning of the area for semi-autonomous and autonomous driving.

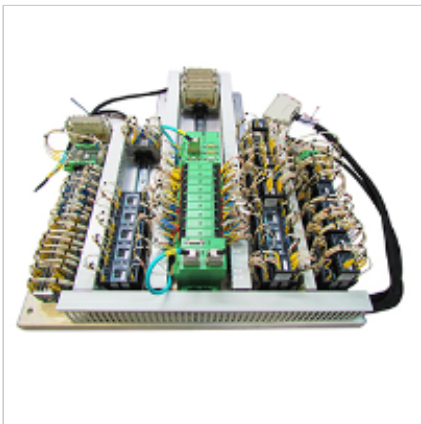

Electrical Plates

Electrical plates for busses, electrobusses, trolleybusses, railway vehicles, including fuses, circuit breakers, relays, and ECUs connected by wire harnesses.



eMobility Harness & Components - North America

Interconnect products for eMobility applications. HV / HP Connectors, Interfaces, Cable Assemblies, Bus Bars, MSD, Vehicle Inlets, PDUs, customized interconnect solutions. Compact low voltage and high voltages harness solutions meet demands of 1000 V DC and up to 450 A.



Energy Management Components

High Voltage Applications - We manufacture customized high-voltage wiring harnesses using Amphenol contact systems. The HV interfaces are specially designed for use in sophisticated applications and are suitable for all temperature ranges of the vehicle. Advantages in terms of size, weight, and power density can be realized.



Engine & Ancillary Components

Connecting Cable for Engine Cooling - The connectors, including the seal, are automatically over-moulded in production cells with lead frame and liquid silicone LSR. Special process steps create the connection to the lead frame, strain reliefs, and longitudinal water tightness.

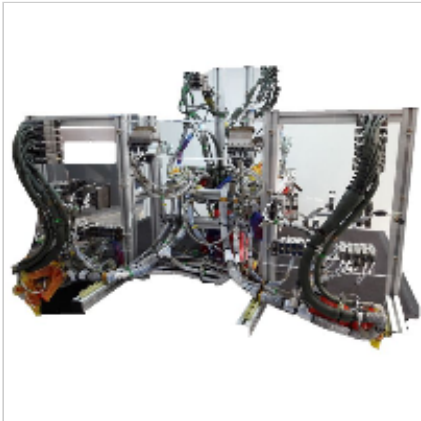

EWIS Harness Electrical Wiring & Interconnect System.

EWIS Harnesses are designed to make the connection of Low Voltage Signals, Power Distribution, RF signals <2GHz, and Fiber Optic; in pressurized or unpressurized sections; in-cabin, cockpit, avionic bay, or even on Space applications. We hold Part21G and PART145 certificates for production and maintenance. We support product design and certification by delivering full documentation.



ExaMAX® 56Gb/s High Speed Backplane Cable Assembly

The ExaMAX® I/O system offers cable assemblies and I/O connector solutions for both internal and external applications. ExaMAX® I/O products are capable of delivering high-speed performance of 25 Gb/s per channel with a path to 40 Gb/s and higher. The ExaMAX® I/O system delivers superior linear board signal density and meets the performance requirements of the OIF-CEI-25G-LR industry standard.



Exhaust Cleaning Harness

Exhaust Gas Sensor - Signals are transmitted between NOx sensors and control electronics using our connection system. Special contact and housing materials are able to resist high exhaust-gas temperatures. By developing our own systems, we achieve low and steady contact resistances, which are needed for the transmission of sensor currents.



Exterior Lighting Harness

Customized Lighting Harness, License Plate Harness



Extremepoint-Flash

Amphenol's Extremepoint-Flash is an extreme low mating height, easy-to-release high-speed cable solution. We designed 95ohm Flash mainly to support near chip (under heat sink) to IO application, and the mating height is lower than 5mm. Flash can support 56G PAM4, and scalable to 112G PAM4 application, and plug is with pull tab design feature for easy release.



Extremepoint-MCIO(Mini Cooledge IO)

Amphenol's Mini Cooledge IO(MCIO) is a high-speed, small mechanical size cable solution. Amphenol MCIO product is now being specified in the SFF group and the project number is SFF-TA-1016. MCIO cable can support PCIe Gen5, and is scalable to PCIe Gen6 and 112G PAM4. We developed 85ohm and 95ohm solutions to support different applications.



Extremepoint-Swift

Amphenol's Extremepoint-Swift is an extreme low profile(mating height<9mm), robust mechanical, and excellent SI performance cable solution. The cable assembly and connector can support PCIe Gen5, and the SI performance is scalable to PCIe Gen6 and 112G PAM4. We can provide straight, right angle, and side exit plug types with 38pin, 74pin, and 124pin to support customers to optimize system layout.

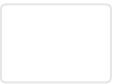

Cable Assemblies

Amphenol’s cable assemblies include simple point-to-point cables, custom high-power and high-speed data cable assemblies and complex multi-branch harness assembly for large systems across a broad range of end markets. Our cable assemblies include the latest industry innovations in radio frequency (RF), fiber optics, high-power requirements and high-speed data transfer for the newest systems and applications. In addition, our broad portfolio of cable connectors and accessories can be used in our cable assemblies to provide a complete solution.



Extremepoint-Z-Link(Gen Z)

Amphenol’s Extremepoint Z-Link(Gen Z) Connector is a scalable connector and connector interface compliant to SNIA: SFF-TA-1002. Z-Link can support PCIe Gen5, and is scalable to PCIe Gen6 and 112G PAM4. Z-Link can support high speed and power in one connector, and we developed 1C, 2C, 4C, and 4C+ connectors to support customers' different applications.



F2X Fiber Optic Building Entry Point

The building entry point (BEP) enables easy connection of buildings to your fiber optic network. The BEP can accommodate different numbers of fibers according to your needs. With the patented F2X® solution you are able to connect and measure FTTX installations faster.



FAKRA Cable Assemblies North America

Coaxial cable solutions used for data transmission and video processing, including options for environments requiring high flexibility and high temperatures



Fiber Optic Data Center Trunk Cable

Trunk cables are used for fixed cabling between network cabinets. Pre-assembled with URM, MPO, or MDC it's application-independent and system-oriented. Especially the URM connector fits perfectly into Base8 cabling systems which are suitable for current and future transmission standards. Smart fixing of the trunk cable in distribution technology due to the integrated cable gland on the divider.



Fiber Optic Fanout Cable

Fanout cables are used for fixed cabling between network cabinets, mainly for breakout applications. System-oriented connector combinations make them application-independent and suitable for all Ethernet and Fibre Channel applications. Usually, 8-fold, 12-fold and 24-fold fanout cable assembled with MPO connectors one side and any common connector type on the other side could be provided.



Fiber Optic Loose Tube Cable

With the pre-assembled loose tube cable, it is possible to connect your distribution technology to protected indoor or outdoor areas. Depending on the application, there is a suitable jacket for robust multi-fiber cable. Various connectors like LC, SC, or E2000 are possible with up to 96 fibers. Jelly-free constructions are available for the lowest fire load.



Fiber Optic Patch Cord

With the patch cords, it is possible to connect your active devices and distribution technology on short distances in the protected indoor area. Due to the lower cable load, more cables can be handled in the same space. Available with different connectors, like LC, SC, or URM, different cables, and fiber number and types.



Fiber Optic Pre-Assembled Cable Drum

Made for mobile applications - the cable drum with universal cable. Stretches can be used in protected indoor areas or in the field. The flexible cable sheath is designed for multiple uses. In addition, the reinforced cable sheath ensures increased tensile and transverse compressive strength. The cable could be assembled with a wide range of connectors, standard as well as more special ones.



Fiber Optic Splice Box Pivotal

Pivotal splice boxes are suitable for splicing up to 96 fibers on one height unit. A secure cable entry is achieved by means of cable glands. Splice-ready pigtails are already laid in the splice boxes, therefore the incoming cable can be installed directly. Available with LC, E2000, and SC adapters.



Fiber Optic Splice Module Twin with Angled Cable Strain Relief

The splice module is designed to fit the 3U subrack and is used to integrate unassembled cables into the network. Equipped with pre-assembled pigtails and a splice cassette it offers an uncomplicated possibility for cable installation. With the angled cable support the fibers are guided perfectly without risk of breaking.



H-Connector

Amphenol's H-Connector assemblies provide a robust and sealed connection solution for FTTH. The H-Connector end incorporates an SC/APC type connection within a slim, sealed, threaded polymer housing allowing easy connection to either the AMT or in-line extension receptacle. The SC/APC connectors mate to a standard adapter. Available with a flat drop or traditional round style OSP cables.



HDMI 2.1 Cables

Amphenol's HDMI 2.1 supports a range of higher video resolutions and refresh rates including 8K@60 HZ and 4K@120HZ, and resolutions up to 10K. Dynamic HDR formats are also supported, and bandwidth capability is increased up to 48Gbps. Amphenol's HDMI2.1 cable has passed the certification, and the mechanical interface is compatible with HDMI2.0 and HDMI1.4.



Headset and Soldier Accessory Cables

Soldier-worn and ruggedized tactical communication cable assemblies. Our overmold technology withstands harsh environmental conditions. Our design team works closely with customers to assist them to achieve SWAP (Size, Weight, And Power).



High Density RF Cable Assemblies

SV Microwave has expanded its offering of fixed-length, high-performance RF cable assemblies with additional high-density configurations. Featuring female SMP, SMPM / VITA 67.3 SMPM and SMPS connectors, these cable assemblies are ideal for embedded system applications or anywhere where space requirements are at a premium.



Highly Flexible Cables

Amphenol LTW provides highly flexible cables for constant moving applications. Ideal for modern automated manufacturing systems. The key features as below: Recommended connectors series: M8, M12, X-LOK, Ceres, USB, RJ45; Bending Standard: TÜV 2 PFG 2577 Class II; Flexing Test: 6 Million Cycles ($S \leq 4\text{mm}^2$); 90° Bending Test: 1 Million Cycles; Cableveyor Test: 5 Million Cycles.



High Speed RF Cable Assemblies

Amphenol SV Microwave offers a complete line of fixed length, high-frequency Ø.047" and Ø.085" cable assemblies in series: SMA, 2.92mm, 2.4mm, 1.85mm, SMP, & SMPM. These assemblies feature low solder wicking, and the high flexibility allows for tight bends behind the cable ferrule. Our low loss is your gain!

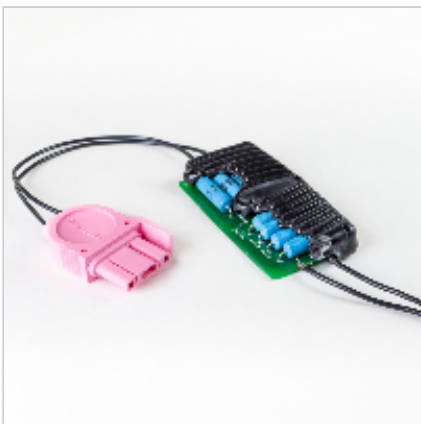

High Voltage Connectors and Cable Assemblies

For decades Amphenol Alden has been partnering with leading medical device manufacturers who require High-Voltage connectors and cable assemblies for their devices. Our portfolio of optimized high voltage solutions helps ensure product safety, efficiency, and versatility. Applications include defibrillation, advanced imaging, cosmetic medicine, LASER therapy systems, and many more.



HPCE® Cable Assembly

The HPCE® cable assembly is a next-generation power cable assembly for demanding applications requiring high linear current density and low power loss. It offers both one-piece (cable to card edge) and two-piece (cable to header) solutions. Both have a low profile height (7.5mm) and are based on very cost-effective and highly reliable stamped-and-formed power contact.



HV Harness Assemblies

Various build-to-print cable assembly including different process assembly such as potting, overmolding, electrical welding

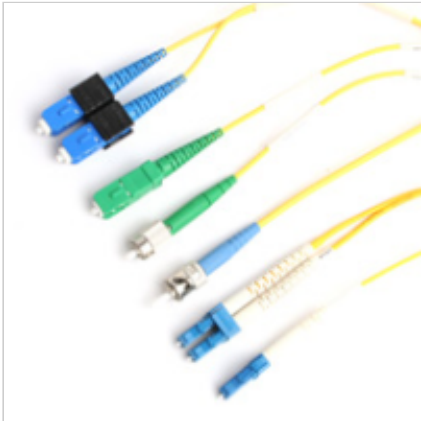

Indoor Cable Assemblies

Amphenol is a premier manufacturer of single-mode and multimode patch cords in the telecommunications industry, meeting or exceeding many of the industry-standard requirements for optical transmission loss, reflectance, visual end face specifications, and geometry. Amphenol offers standard patch cords in a variety of configurations and connector types.

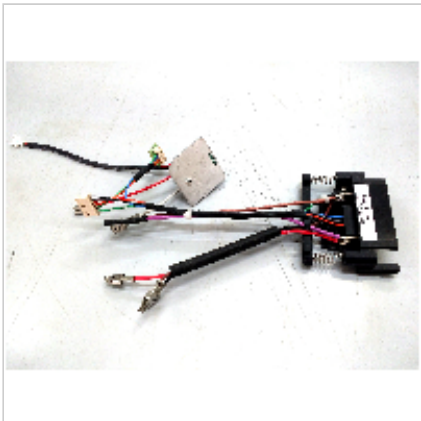

Industrial Cable Assembly

Wire harness for power tools



Industrial Cable Assembly

Value add solution for solar application



Industrial Cable Assembly

Wire harness for industrial application



Industrial Cable Assembly

Value add solution for railway application



InstaBend 086

INSTABEND™ are flexible, coaxial microwave assemblies designed for interconnects between RF circuit cards, modules, and enclosure panels. The cable can be bent very closely behind the connector, simplifying cable routing.

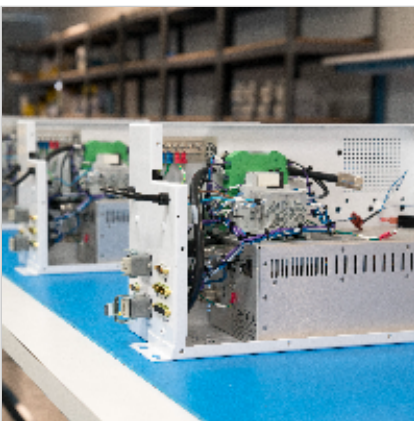

Integrated Electronic Mechanical Device

Amphenol DC Electronics manufactures Integrated Electronic Mechanical Devices and custom box builds designed to offer optimum protection for your wire harnesses and cable assemblies. Box builds are effective in the number of purposes they can serve, from enclosing controls or electronics and connections to protecting them in a number of potentially hazardous settings.



IPS (Integrated Product Solutions) Series

Amphenol's IPS series is an integrated cable solution for high-speed card edge connectors like PCIe®. Compared to the traditional card-to-board application, this will extend the connection from simplified card-to-card to multiple gender options for connector-to-connector, connector-to-card, or card-to-card configurations.



Keyed SMA RF Cable Assemblies

SV Microwave just released fixed length Keyed SMA cable assemblies that offer an ideal solution when polarization is required. These new Keyed SMA connectors are available in 4 unique keying configurations and are cabled to standard SMAs using Ø.085 cable. This new self-aligning design offers more space savings than other bayonet style connectors.



Large Core Multimode Fiber Optic Assemblies

The range of applications for large core multimode fibers is very large, and the fiber portfolio is correspondingly diverse. Together with our suppliers as partners, we can provide the appropriate multimode fiber, up to 1500um core size, for your application or design.



Lighting Harness China / Asia

Interconnect solutions for headlamp, DRLs, FOG, Trunk, Stop, liftgate, turns lights



LMR® 195

Times LMR cable assemblies are a high-performance broadband, flexible, low-loss RF coaxial cables that can be used virtually anywhere, either indoors or outdoors. As a completely Times manufactured solution, performance and reliability are assured.



LMR® 240

Times LMR cable assemblies are a high-performance broadband, flexible, low-loss RF coaxial cables that can be used virtually anywhere, either indoors or outdoors. As a completely Times manufactured solution, performance and reliability are assured.



LMR® 400

Times LMR cable assemblies are a high-performance broadband, flexible, low-loss RF coaxial cables that can be used virtually anywhere, either indoors or outdoors. As a completely Times manufactured solution, performance and reliability are assured.



Low Profile RF Cable Assemblies

SV Microwave just released a new line of Low Profile RF cable assemblies that incorporate a unique ferrule design that protects the cable from overbending while maintaining a shorter distance from the front of the coupling nut to the back of the cable bend than standard offerings. The ferrule radius prevents the cable's overbending, which can cause defects that can lead to rework.



LPA-500-LLPL

1/2" Air-Dielectric Corrugated Plenum Cable is a low-loss, plenum listed (type CMP) coaxial cable. This design offers excellent intermodulation performance and can be used as feedlines within buildings to support distributed antenna systems (DAS).



LV Harness Assemblies

Various build-to-print cable assembly including different process assembly such as potting, overmolding, electrical welding



MaxGain® 130

MaxGain® Assemblies are high-performance, ultra-low-loss microwave coaxial cables. Built with our unique spiral outer conductor technology, this lightweight cable is a reliable, high-frequency interconnect solution.



MaxGain® 160

MaxGain® Assemblies are high-performance, ultra-low-loss microwave coaxial cables. Built with our unique spiral outer conductor technology, this lightweight cable is a reliable, high-frequency interconnect solution.



MaxGain® 200

MaxGain® Assemblies are high-performance, ultra-low-loss microwave coaxial cables. Built with our unique spiral outer conductor technology, this lightweight cable is a reliable, high-frequency interconnect solution.



MaxGain® 300

MaxGain® Assemblies are high-performance, ultra-low-loss microwave coaxial cables. Built with our unique spiral outer conductor technology, this lightweight cable is a reliable, high-frequency interconnect solution.



Medical Assemblies

The Amphenol 905 series was the first fiber optic interconnect system to gain industry-wide acceptance. Today, we support these markets with a variety of standard and custom SMA connectors and accessories. Our long-standing history and development of the SMA product ensure exceptional quality and long-term reliability. The SMA is an excellent choice for a robust, cost-competitive solution.



Metric RF Cable Assemblies

SV Microwave now offers fixed-length Ø.085" RF cable assemblies in standard 250mm and 500mm lengths. Available in straight and right angle orientations for SMA, 2.92mm, SMP, and SMPM series.



Micro Coax Harness

Amphenol is one of the leading providers of MCX cable solutions on the market. The current market demands a more integrated connectivity solution, including integrated hinge/MCX cable assemblies. Our Micro Coax Cable assembly is designed for high-speed transmission, high EMI shielding, and a very small bundle diameter for optimal spacing in tight applications.



MIL-22992 Class L Heavy Duty Power Cables

Amphenol MIL-22992 Class L assemblies are suited for Industrial and Military applications. These connectors and cable assemblies are designed to meet demands, ranging from 40 to 200 amps, for military shelters, vehicles, and remote power generation.



MIL-C-55116 Mil/Com Cables

Amphenol Tactical Communications (ATC) Cable Assemblies are designed to be used in harsh environment applications. The AP Series Cable Assemblies are provided as finished, turnkey, factory-assembled, molded, cable assemblies. These assemblies are used to interface with all MIL-C-55116 applications such as military radio applications, ruggedized laptops, and intercom systems.



MilTech®-210

MILTECH® Assemblies are the qualified family of hermetically sealed flexible RF and microwave transmission line assemblies that are optimized and qualified for commercial, military airborne, and other demanding applications.



MilTech®-230

MILTECH® Assemblies are the qualified family of hermetically sealed flexible RF and microwave transmission line assemblies that are optimized and qualified for commercial, military airborne, and other demanding applications.



MilTech®-265

MILTECH® Assemblies are the qualified family of hermetically sealed flexible RF and microwave transmission line assemblies that are optimized and qualified for commercial, military airborne, and other demanding applications.



MilTech®-300

MILTECH® Assemblies are the qualified family of hermetically sealed flexible RF and microwave transmission line assemblies that are optimized and qualified for commercial, military airborne, and other demanding applications.



MilTech®-340

MILTECH® Assemblies are the qualified family of hermetically sealed flexible RF and microwave transmission line assemblies that are optimized and qualified for commercial, military airborne, and other demanding applications.

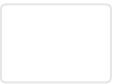

Cable Assemblies

Amphenol’s cable assemblies include simple point-to-point cables, custom high-power and high-speed data cable assemblies and complex multi-branch harness assembly for large systems across a broad range of end markets. Our cable assemblies include the latest industry innovations in radio frequency (RF), fiber optics, high-power requirements and high-speed data transfer for the newest systems and applications. In addition, our broad portfolio of cable connectors and accessories can be used in our cable assemblies to provide a complete solution.



MilTech®-480

MILTECH® Assemblies are the qualified family of hermetically sealed flexible RF and microwave transmission line assemblies that are optimized and qualified for commercial, military airborne, and other demanding applications.



MILVA NGVA D38999 Cordsets & Jumpers

Amphenol SOCAPEX MILVA NGVA D38999 Cordsets & Jumpers are factory tested and ready to install cordsets. They are designed & manufactured according to MILVA NVGA Ethernet and USB overmolded cables per NGVA STANAG 4754 standard (NATO Generic Vehicle Architecture).



MILVA NGVA USB Cordsets & Jumpers

Designed to perform in the harshest environments, the rugged MIL-DTL-38999 Series III plugs are overmolded on tactical Ethernet or USB cables per NGVA STANAG 4754 standard (NATO Generic Vehicle Architecture). This turn-key solution allows you to connect any NGVA compliant equipment onto any NGVA military vehicle network.



Mini-FAKRA Cable Assemblies North America

Mini coaxial connectors offer a compact solution, compared to the conventional FAKRA connector. These connectors can support frequencies of up to 15GHz and data rates up to 28Gbit/s.



Mini-SAS Copper Cable Assemblies 3G/6G

Amphenol's external Mini-SAS cable assembly solutions address the current and legacy storage industry's demand for a reliable, compact, high-speed serial I/O supporting SAS 2.1. Mini-SAS solutions satisfy the applicable requirements of the INCITS T10 and SAS 2.1 specification and conform to the mechanical requirements described in the SFF-8086 and SFF-8088 documents.



Mini-SAS HD Active Optical Cable

Amphenol's Mini-SAS HD Active Optical Cable is fully compliant with SAS 2.1 and SAS 3.0 industry standards as well as the SFF-8636 interface standard. Used primarily for external Enterprise storage applications, this cable is part of Amphenol's comprehensive Mini-SAS HD product offerings that address all board connector and cabling applications, from 1 to 100 meters.



Mini-SAS HD Copper Cable Assemblies 6G/12G/24G

Amphenol's Mini-SAS HD product is the present generation SAS storage interface addressing multi-channel bandwidth requirements of 6Gb/s, 12Gb/s, and 24Gb/s while meeting or exceeding SAS 2.1 SAS 3 and SAS 4 specifications. The Mini-SAS HD product provides greater port density (11mm port-to-port) versus the legacy Mini-SAS 2.1 product (19.01mm port-to-port).



Mirror Harness Assemblies

Wire Harness for Car Mirrors, Components for Car Mirrors, Connectors for Car Mirrors.



Molded Custom Cable Assemblies

Amphenol DC Electronics can manufacture custom overmolded cable assemblies designed for today's sophisticated applications. We have the engineering, design facilitation, and technology resources to take a cable assembly concept and transform it into a solution that can be manufactured to meet the demands of your application.



MotionGrade Series

MotionGrade™ M23 and M40 Circular DIN Connectors are designed to excel in performance and reliability in the most demanding environments. All M23 and M40 products are IP67 rated. Ideally suited for advanced servo drive encoder feedback applications, packaging, robotic, printing, machine tool, medical and automation environments



MQ4

Small size with integrated design for high-density connection. Low-cost connection with less cable usage.



OCP ORv3

Designed based on three decades of experience developing power connectors for specific applications. For use in power shelves, servers, or any other aspect of OCP power management. Extended efforts include offering turn-key AC whip cable assemblies to ORV3 specifications.



OCTIS™ - Hybrid Connectors and Cable Assemblies

FCI Basics OCTIS™ I/O connectors and cable assemblies on a hybrid interface promote both signal and power transmission over Cat 5e cable in outdoor and harsh environments. It offers lightning protection, EMI shielding, and is field-installable. The transceiver is held outside the telecom box helping to save on board space and bettering the thermal distribution prospects.



OCTIS™ - Power Connectors and Cable Assemblies

FCI Basics OCTIS™ I/O connectors and cable assemblies using Amphenol's PwrProfile® interface promote high power transmission in outdoor and harsh environments. It offers lightning protection, EMI shielding, and is field-installable. The transceiver is held outside the telecom box helping to save on board space and bettering the thermal distribution prospects.



OCTIS™ - RJ45 Connectors and Cable Assemblies

FCI Basics OCTIS™ I/O connectors and cable assemblies using the RJ45 standard interface promote Ethernet-friendly signal transmission in outdoor and harsh environments. It offers lightning protection, EMI shielding, and is field-installable. The transceiver is held outside the telecom box helping to save on board space and bettering the thermal distribution prospects.



OCTIS™ - Signal Connectors and Cable Assemblies (Metral® HDXS)

FCI Basics OCTIS™ I/O connectors and cable assemblies using Amphenol's Metral® HDXS interface promote signal and PoE++ transmission over Cat 5e and 6 cables in outdoor and harsh environments. It offers lightning protection, EMI shielding, and is field-installable. The transceiver is held outside the telecom box helping to save on board space and bettering the thermal distribution prospects.



Omni-Path Copper Cable Assemblies 100G

The Omni-Path verified DAC copper cables, are offered to address the needs of the majority of the inter-cabinet & short-reach intra-cabinet cable connections while minimizing cable bulk & cable routing issues, up to 4 meters using 30AWG cable. Longer-length cables up to 6 meters also maximize the length of copper. These longer cables use 26AWG high-performance bulk cable.



OSFP Copper Cable Assemblies 200G/400G

200G / 400G SOLUTIONS Amphenol's leading the industry in OSFP cable development. OSFP (Octal Small Form Factor Pluggable) cable assemblies are compatible with both 25G/ lane channel NRZ and 50G/lane channel PAM4 signaling protocols that allow the cables to deliver aggregate bandwidths of 200G and 400G per cable assembly.



OSFP Loopback 200G/400G

OSFP (Octal SFP) Loopback Modules are part of our OSFP I/O system product family that includes copper cables, connectors, and AOC's. These OSFP loopback cable assemblies are offered in four configurations - Passive Electrical, Passive Thermal, Active Electrical, Active Thermal. All loopback cable assemblies support 200G (8 lanes @ 25G NRZ) or 400G (8 lanes @ 50G PAM4) signaling transmission.

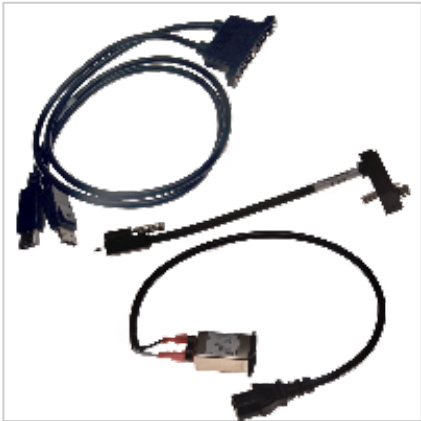

Over-Molded Cables

Amphenol-CTI overmolding technologies work in many applications; offering the best-value solutions to your interconnect challenges. Certifications: UL, CSA, ISO9001, CE, IPC 620, WHMA, C-TPAT, IATF16949 (and others) Capabilities: Multi-conductor data cables (DVI, HDMI, USB, etc) / Filtered Power / Custom molds / Soft or hard tooled, 3D printing molds / Single/multiple cavities / PVC/PP/ABS/TPU/PBT

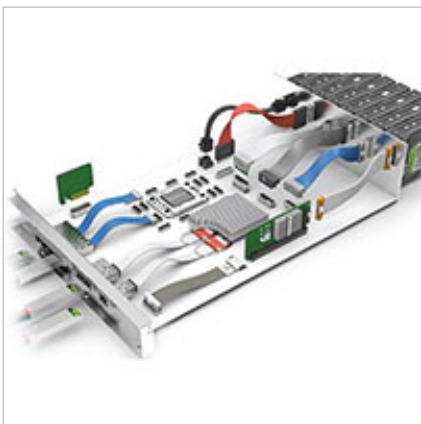

OverPass™ Cable System

Amphenol's OverPass™ cable system offers a broad range of capabilities that allow our customers to efficiently transmit high-speed signals from near an ASIC to anywhere in their system.



PANEL MOUNT BULKHEAD RF CABLE ASSEMBLIES

SV Microwave just released standard SMA and 2.92mm female bulkhead cable assemblies used to transmit a signal through a panel using a single mounting hole. The bulkhead connector style allows installation through a box or panel without the use of screws. The fastening nut is installed around the front of the connector on the outside of the box or panel.



Perma-Tap® Power Cable Assembly

Perma-Tap® power cable assembly saves space and reduces cost. The wires can be cut, stripped, and terminated to customer-specific lengths. The connector is press-fit to a PCB to provide a compact and secure power delivery solution. A permanent connection between a cable and a PCB with only one connector.



PhaseTrack®-047

PT-047 is a low-loss, highly flexible, foam-core micro coaxial cable. Originally designed for space satellite programs, this high-performance cable has many applications across multiple markets.



Pre-Assembled SMPTE Cables

By means of a pre-assembled SMPTE cable, you as a user are well prepared for a trouble-free transmission of HDTV signals, even for long distances. The pre-assembled SMPTE cables provide all the needed properties to withstand almost any environment for your safe data transmission. All SMPTE cables could be assembled with all connectors of the 3K.93C series.



Precision Test Cables

Amphenol RF offers pre-configured RF test cables designed for high-performance applications requiring minimal insertion and return loss. They are ideal for test and measurement applications and each assembly is tested to ensure electrical and mechanical performance.



Prefabricated Cable

The origin of the power connection – FTG in Triberg has been manufacturing pre-assembled cables for connecting electrical power since 1962. The cable harnesses can be put together individually in lengths, 0,75 to 95 sqmm cross-section, colors, and the type of assembly, whether with wire end sleeves, cable lugs, or the new and save technique of ultrasonically welded cable ends.



PT-MPO

Amphenol harsh environment PT-MPO plug assemblies and mating receptacles leverage the proven MIL-DTL-26482 spec connector system to provide an environmental seal and mechanical protection for 4 to 24 fiber MPO style connections. It is quick to deploy, requiring only ¼ turn. It is metal construction and has a positive latching system (both audible and visual). Ideally suited as a trunk for FTTA.



pulseOne Cable Assemblies

The pulseOne over-molded plug and receptacle cable assemblies are designed to meet the growing need for simple, standard, readily available medical-grade cable assemblies. Its ergonomic shape, environmental sealing features, and affordability make pulseOne an ideal choice for diagnostic, therapeutic, and surgical devices, as well as human-worn applications.



PwrBlade® Cable Assembly

The PwrBlade® cable connectors are designed to mate to PwrBlade® R/A or vertical board-mounted headers. By expanding beyond BTB applications, designers can now connect power supplies and power distribution sub-assemblies in a wider range of applications. The combination of cable connection capability with Amphenol's proven PwrBlade BTB system provides a universal power distribution connector.



Pwr TwinBlade® Cable Assemblies

The Pwr TwinBlade® cable system is designed to support applications that demand the supply of high power. The Pwr TwinBlade® connectors employ a proven contact system in a touch-proof design that is capable of supporting currents of up to 100A per contact. The new sensing contacts can be used to eliminate the potential for damage from hot-plug conditions.



QSFP28/56 Loopback Modules

Amphenol's QSFP28/56 Loopback Modules are part of our comprehensive QSFP28/56 product family which includes copper cables, active optical cables, and connectors. These QSFP28/56 loopbacks are offered as passive electrical with multiple attenuations and thermal consumption levels. QSFP28/56 loopbacks are designed to support data speeds up to 100G/200G (4 lanes at 25G/50G).



QSFP28 Active Optical Cable

COST-EFFICIENT, HIGH PERFORMANCE, PLUG AND PLAY INTERCONNECT SOLUTIONS
Amphenol's 100G QSFP28 to QSFP28 Active Optical Cable assemblies are a reliable, cost and power-efficient, integrated solution which is ideal for high-density signal transmission typically seen in most storage, data centers, and high-performance computing applications with fiber cable length up to 100meters.



QSFP28 Cable Assemblies

THE INDUSTRY LEADER IN 100G / 200G / 400G QSFP28 CABLE ASSEMBLIES
Amphenol's QSFP28G cable assembly is designed to meet data center, networking, and high performance computing application needs for high-density cabling interconnect systems capable of 28Gb/s to 112Gb/s per channel transmission rates.



QSFP Copper Cable Assemblies 100G/200G

Amphenol's QSFP28G cable assembly is designed to meet data center, networking, and high-performance computing application needs for high-density cabling interconnect capable of 28Gb/s per channel transmission rates. The QSFP28G supports the bandwidth transmission requirements for 100G Ethernet, Infiniband IBTA FDR and EDR, Fibre Channel FC-PI-5 and FC-PI-6 standards, and SAS-3 specifications.



QSFP DD 200G Active Optical Cable

Amphenol QSFP DD to QSFP DD 200G Active Optical Cable assemblies increase the number of lanes from 4 to 8 and double the port density as compared to 100G QSFP28 AOC. The QSFP DD AOCs operate up to 25Gb/s NRZ modulation and provide solutions up to 200Gb/s aggregate bandwidth, supporting 100meters over parallel multimode fiber.



QSFP DD Copper Cable Assemblies 200G/400G

200G / 400G SOLUTIONS Amphenol's QSFP DD (Double-Density) passive copper cable assemblies double the number of high 25G/lane NRZ and 50G/lane PAM4 when compared to the existing 100G QSFP cabling systems from 4 to 8 lanes. The QSFP DD cables enable 200G or 400G in application lengths from 0.5 meters up to and including 2.5 meters.



QSFP DD Loopback 200G/400G

QSFP DD loopback cable assemblies are offered in four configurations - Passive Electrical, Passive Thermal, Active Electrical, Active Thermal. All loopback cable assemblies are backward plug compatible with existing 100 G-based systems and support 200G or 400G signaling transmission.



QSFP+ Active Optical Cables

Amphenol's QSFP+ to QSFP+ active optical cable assemblies provide 4 fully duplex channels per cable supporting signal transmission rates up to 10 Gb/s & 14 Gb/s per channel. The QSFP+ cable interface is based on the SFF-8436 industry standard, while also meeting the requirements of the 40GBASE-SR4 Ethernet and Infiniband SDR, DDR, QDR & FDR standards.



QSFP+ Cable Assemblies

QSFP connector, cage, and cable assemblies are designed to meet emerging data center and high-performance computing applications of delivering aggregate data bandwidths of 40Gb/s & 56 Gb/s & 112 Gb/s. This interconnect is fully compliant with existing industry standard specifications such as the QSFP MSA and IBTA.



QSFP+ Copper Cable Assemblies 40G

QSFP (Quad Small Form Factor Pluggable) cable assemblies are designed to meet emerging data center and high performance computing application needs for high-density cabling interconnect systems capable of delivering aggregate data bandwidths of 40Gb/s. The QSFP cables support bandwidth transmission requirements as defined by IEEE802.3ba (40Gb/s) and Infiniband QDR (4x10Gb/s per channel).



QSFP+ Loopback Modules

Amphenol's QSFP+ Loopback Modules are part of our comprehensive QSFP+ product family which includes copper cables and connectors. These QSFP+ loopbacks are offered as passive electrical with multiple attenuations and thermal consumption levels. QSFP+ loopbacks are designed to support data speeds up to 40G (4 lanes at 10G).



QSFP+ to 4x SFP+ Copper Splitter Cable Assemblies 40G

40G QSFP+ to 4x SFP+ splitter cable assemblies are designed to meet emerging data center and high performance computing application needs for a high-density cabling interconnect system capable of delivering aggregate data bandwidths of 40Gb/s at QSFP end and 10G at SFP end. This interconnect system is fully compliant with existing industry standard specifications such as the QSFP MSA and SFP MSA.



QSFP to 2x QSFP Copper Splitter Cable Assemblies 100G/200G

The QSFP28 to 2xQSFP50 Y cable assembly supports the bandwidth transmission requirements as defined by 100 Gigabit-Ethernet (IEEE 802.3bj) and 25 Gigabit-Ethernet (IEEE 802.3by). Amphenol's QSFP28 100Gb interconnect system complies with industrial standards SFF-8665 / SFF-8402, GR-253-CORE, Gigabit-Ethernet (IEEE 802.3bj and IEEE 802.3by), FC-PI-5, and FC-PI-6.



QSFP to 4x SFP Copper Splitter Cable Assemblies 100G/200G

Amphenol's QSFP28 - 4XSFP28 Splitter cable assembly is designed to meet data center, networking and high performance computing application needs, for high-density cabling interconnect system, capable of 28Gb/s per channel transmission rates. It is designed to meet the requirements of Small Form Factor industry-standard SFF-8665 /SFF-8402.

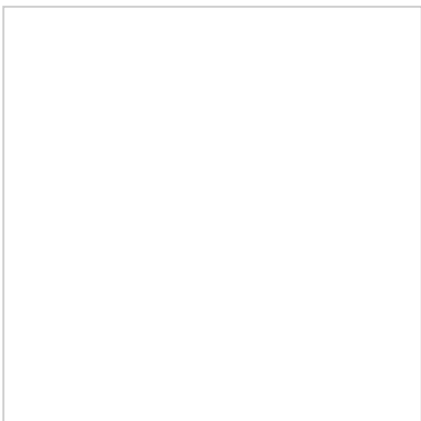

QuickbuildRF Configurator

Amphenol Custom Cable and Amphenol RF have partnered to bring to market the QuickbuildRF Configurator. Set up your account today to custom configure your Quick Turn RF Assemblies. Receive immediate, real-time price, quick delivery due to large stock levels.



RCx Copper Cable Assemblies 25G/50G/100G

Amphenol's RCx is a low-cost passive copper connector and cable system, specifically designed for intra-rack connectivity of 25Gb, 50Gb, and 100Gb Ethernet. It is designed to address multiple high-speed high-performance hardware needs. It provides lower cost and higher density solutions compared to traditional SFP28/QSFP28 cables.



RF Cable Assemblies With Strain Relief Boot

SV Microwave just released a new line of strain relief cable assemblies that feature a new boot to protect the sensitive cable termination area and allow for more flexibility and peace of mind. These test cable assemblies are available with male SMA, 2.92mm, 2.4mm or 1.85mm connector series.



RF Low Loss Cable Assemblies With Strain Relief Boot

SV Microwave released a new line of strain relief cable assemblies that feature a molded boot to protect the sensitive cable termination area and allow for more flexibility and peace of mind. Additionally, these cable assemblies feature SV's Ø.087" Low Loss cable type that provides slightly more flexibility and less insertion loss than our standard Ø.085" cable.



Right Angle SMA 2.92mm Connectors and Cable Assemblies

SV Microwave's right angle cable assemblies and connectors provide excellent electrical performance from DC up to 40 GHz. No need to sacrifice performance for space, these high-performance connectors are compact in size and have outstanding durability. Currently available for Ø.047" and Ø.085" cable types and in SMA and 2.92mm series.

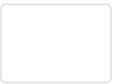

Cable Assemblies

Amphenol’s cable assemblies include simple point-to-point cables, custom high-power and high-speed data cable assemblies and complex multi-branch harness assembly for large systems across a broad range of end markets. Our cable assemblies include the latest industry innovations in radio frequency (RF), fiber optics, high-power requirements and high-speed data transfer for the newest systems and applications. In addition, our broad portfolio of cable connectors and accessories can be used in our cable assemblies to provide a complete solution.

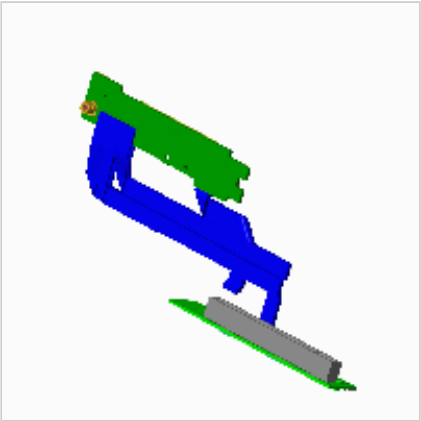

Riser Card Cable

Amphenol has developed variant riser card high-speed cable solutions for different system architecture designs to optimize system space layout. Meanwhile, AST solution can provide an entire riser card solution with more value-added PCBA design and assembly. We designed a riser card cable solution mainly to support PCIe Gen5 application, and it's scalable to PCIe Gen6.



RJ45 TV Cordsets & Jumpers

Factory tested and ready to install.



Ruggedized Ethernet & USB Cables

High-reliability Cat 5e cable and RJF / USB cable assemblies designed both for harsh or industrial environments. Cat5e cables are designed to ISO/IEC11801 requirements. Our extensive offering of Ethernet, USB, FireWire, and ESATA connectors can be sold as cord sets with molded plugs and/or transversal receptacle sealing.



Safety Harness

Cable Assembly including designed mechatronic parts for clockspring activation with a compact design.



Safety Harness Europe & North America

Safety Harnesses are available in various combinations and can be customized to customer specifications and needs.



Service Node

Amphenol’s service node links optical transport cable to optical processing equipment. This connection is critical and requires an environmental seal between the cable and the node feed-thru. Amphenol’s node cables utilize a unique IP68 rated stainless steel feed-thru adapter, featuring an anti-twist coupling body and an optional anti-rotating nut.



SFP28 Loopback Modules

SFP28 PORT TESTING SOLUTION Amphenol's SFP28 MSA compliant Loopback Modules are part of Amphenol's comprehensive copper cable and connector product family. Offered as passive electrical, all versions of this connector come without EMI spring fingers, reducing the insertion and extraction force.



SFP Copper Cable Assemblies 25G/50G

Amphenol's SFP28 cable assemblies are designed to support applications for 25G Ethernet and 32G Fibre Channel. Amphenol SFP28 products offer ultra-high performance, cost-effective solutions for 25-Gigabit speed applications in switched fabric I/O, switches, routers, data storage arrays, and high-performance computer (HPC) clusters.



SFP+ Copper Cable Assemblies 10G

Amphenol's SFP+ cable assembly is designed to meet data center, networking, and high-performance computing application needs for a high-density cabling interconnect system capable of 10 Gb/s per channel transmission rates. It is designed to meet the requirements of Small Form Factor industry-standard SFF-8431.



Small Harness for Harsh Environment

Engine Wire Harness, Tailgate Wire Harness, Door Wire Harness



Structure Plus™ Family

Amphenol Sine Systems’ StructurePlus™ Family of overmold-compatible connectors are engineered, one-piece, solid body connectors that are specifically designed for cable assembly operations requiring custom molding or shrink tube requirements. The added connector structure results in enhanced connection integrity that is an essential component for connecting cable in harsh environments.



Sunroof Harness

Wiring harnesses for driving sunroofs and sunshades or other automotive applications



SuperFlex Ø.047" RF Cable Assemblies

SV Microwave offers fixed-length RF cable assemblies using its extremely pliable SuperFlex Ø.047" cable. SV's SuperFlex product line includes right angle and straight SMP and SMPM connectors for unmatched routing in tight spaces. This super flexible coax cable is capable of extreme bends, which allow it to fit in tight spaces and route for any application. Available in series: SMP, SMPM and SMA.



SuperFlex RF Cable Assemblies

Amphenol SV Microwave now offers fixed-length RF cable assemblies using its most flexible Ø.047" cable yet! This super flexible coax cable is capable of extreme bends which allow it to fit in tight spaces and route for any application. Cable assembly configurations are currently available using SMA and/or SMPM connector series at 6” and 12” lengths. Custom variations are available as well.



Switch Assemblies China / Asia

Cable assemblies with integrated switches for SRS buckle detection, horn switch, and other automotive micro switch applications. Buckle switch and sensors with mechanical switch, hall sensor, and slider switch / PCB.



Switchgears

Switchgears (high voltage and low voltage) including fuses, circuit breakers, contactors, relays, and ECUs connected by wire harnesses. The following types of cables are used in the production of switchboards - H&S Radox or Nexans.



TCA Cable Assemblies

Lightweight, low loss, higher temperature, highly flexible cable for avionics and communications up to 12 GHz.



Telecom Cable Assembly

Mini MDR double decker overmolded



Telecom Cable Assembly

Wire wrapping solution



Transmission Harness

Our complex cable sets are used in classic and hybrid double-clutch transmissions as well as 8- and 9-speed automatic transmissions. Oil tightness and optimum connection technology under the most extreme conditions are of the highest technical relevance and are achieved through our many years of experience in this product sector.



Ultraport-CooLink

Amphenol's CooLink is an auto-grade high-speed cable for autonomous driving applications. CooLink can meet USCAR2 and LV214 spec, and high temperature up to 85°C, 105°C and 130°C. CooLink can support PCIe Gen4 and Gen5, and is scalable to PCIe Gen6. We designed CooLink with CPA and a second lock feature to meet auto vibration tests.



Ultraport-LP SlimSAS

Amphenol LP SlimSAS is a high-speed cable solution with low mating height, and it's a qualified cable solution by UPI1.0. LP SlimSAS can support PCIe Gen5, and its footprint is compatible with standard SlimSAS. Amphenol developed 38pin, 74pin and 124pin LP SlimSAS with straight, right-angle, and side exit plug types to provide customers a flexible system layout.

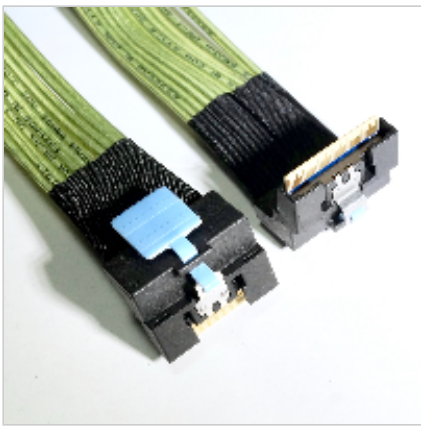

UltraPort-SlimSAS

Amphenol's SlimSAS is a high-speed and robust cable assembly solution, and supports multiple industry applications such as PCIe, SAS, OpenCAPI, UPI1.0, OCP, NVME, and Ethernet. Amphenol has developed a scoop-proof connector solution with a pull tab. Amphenol develops a 38pin and 74pin solution and has been specified in the SFF group(SFF-8654).



USB4 Type C Cables

Amphenol's USB4 is the most recent update of the USB specification and supports a range of higher video resolutions, high data bandwidth, power. The bandwidth capability is increased up to 40Gbps in two lanes. Amphenol's USB4 cable has passed the certification of USB4 Gen3 spec, and the TID number is 4266. The mechanical interface is compatible with USB3.2 and Type C.



USB Field TV Cordsets & Jumpers

USBF TV & USB3F TV with USB cables cordsets.



Waterproof (IP68 Rated) RF Cable Assemblies and Interconnects

SV Microwave offers a wide range of IP67 and IP68 waterproof cable assemblies and interconnect products designed to withstand rigorous environments and harsh elements. SV's waterproof cable assemblies include o-ring sealed connectors to 1 x 10⁻⁸ cc/sec, making them ideal for high pressure, harsh environment applications and for the prevention of dust, liquid or gas leakage.



Wire and Cable Harnesses

Electrical installation for buses, special vehicles, machines (construction and agricultural), marine, and rolling stock (low and high voltage). Traditional and CAN-based installation (power, signal, communication wires, and cables), with various means of protection.



Wire Harness Assemblies

Small to large and low to complex wire harness assemblies with up to 1000 circuits, for on-road and off-road specialty vehicles and military ground vehicles. Production volumes range from low to high volume and include ultra-low prototypes and quick turn requirements. Applications include over-molding. Production resources are in the U.S. and Mexico. We have ITAR certification and DoD MLAs.

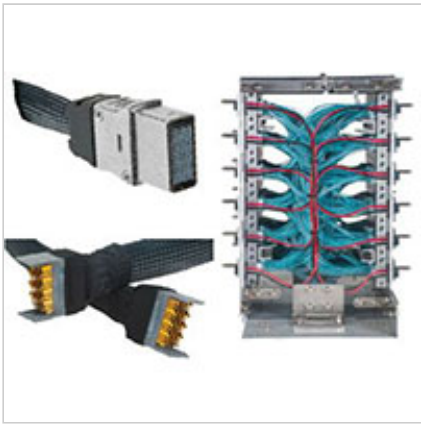

XCede® Family Cable Assemblies

Cable Backplane Systems is part of Amphenol's Highspeed Backplane Product business, dedicated to developing and manufacturing cabled backplane solutions for next-generation system architectures. Our customers are leading providers of data center switches and routers, enterprise servers, and high-performance computers.

Алматы (7273)495-231
Ангарск (3955)60-70-56
Архангельск (8182)63-90-72
Астрахань (8512)99-46-04
Барнаул (3852)73-04-60
Белгород (4722)40-23-64
Благовещенск (4162)22-76-07
Брянск (4832)59-03-52
Владивосток (423)249-28-31
Владикавказ (8672)28-90-48
Владимир (4922)49-43-18
Волгоград (844)278-03-48
Вологда (8172)26-41-59
Воронеж (473)204-51-73
Екатеринбург (343)384-55-89

Иваново (4932)77-34-06
Ижевск (3412)26-03-58
Иркутск (395)279-98-46
Казань (843)206-01-48
Калининград (4012)72-03-81
Калуга (4842)92-23-67
Кемерово (3842)65-04-62
Киров (8332)68-02-04
Коломна (4966)23-41-49
Кострома (4942)77-07-48
Краснодар (861)203-40-90
Красноярск (391)204-63-61
Курск (4712)77-13-04
Курган (3522)50-90-47
Липецк (4742)52-20-81

Магнитогорск (3519)55-03-13
Москва (495)268-04-70
Мурманск (8152)59-64-93
Набережные Челны (8552)20-53-41
Нижний Новгород (831)429-08-12
Новокузнецк (3843)20-46-81
Ноябрьск (3496)41-32-12
Новосибирск (383)227-86-73
Омск (3812)21-46-40
Орел (4862)44-53-42
Оренбург (3532)37-68-04
Пенза (8412)22-31-16
Петрозаводск (8142)55-98-37
Псков (8112)59-10-37
Пермь (342)205-81-47

Ростов-на-Дону (863)308-18-15
Рязань (4912)46-61-64
Самара (846)206-03-16
Санкт-Петербург (812)309-46-40
Саратов (845)249-38-78
Севастополь (8692)22-31-93
Саранск (8342)22-96-24
Симферополь (3652)67-13-56
Смоленск (4812)29-41-54
Сочи (862)225-72-31
Ставрополь (8652)20-65-13
Сургут (3462)77-98-35
Сыктывкар (8212)25-95-17
Тамбов (4752)50-40-97
Тверь (4822)63-31-35

Тольятти (8482)63-91-07
Томск (3822)98-41-53
Тула (4872)33-79-87
Тюмень (3452)66-21-18
Ульяновск (8422)24-23-59
Улан-Удэ (3012)59-97-51
Уфа (347)229-48-12
Хабаровск (4212)92-98-04
Чебоксары (8352)28-53-07
Челябинск (351)202-03-61
Череповец (8202)49-02-64
Чита (3022)38-34-83
Якутск (4112)23-90-97
Ярославль (4852)69-52-93

Россия +7(495)268-04-70 Казахстан +7(7172)727-132 Киргизия +996(312)96-26-47

<https://amphenol.nt-rt.ru/> || aox@nt-rt.ru